

File location: P:\6 Schemes\SCHMES 2019-20\Integrated Trane\220631 - Ashvok Road, Stofold\Stage 3A - Detailed Design\2_CAD - Detailed Design\2_CAD - Detailed Design\2_CAD - Detailed Design\220631.dwg User: Michael Hinchley Time: 17 January 2020 10:44:41

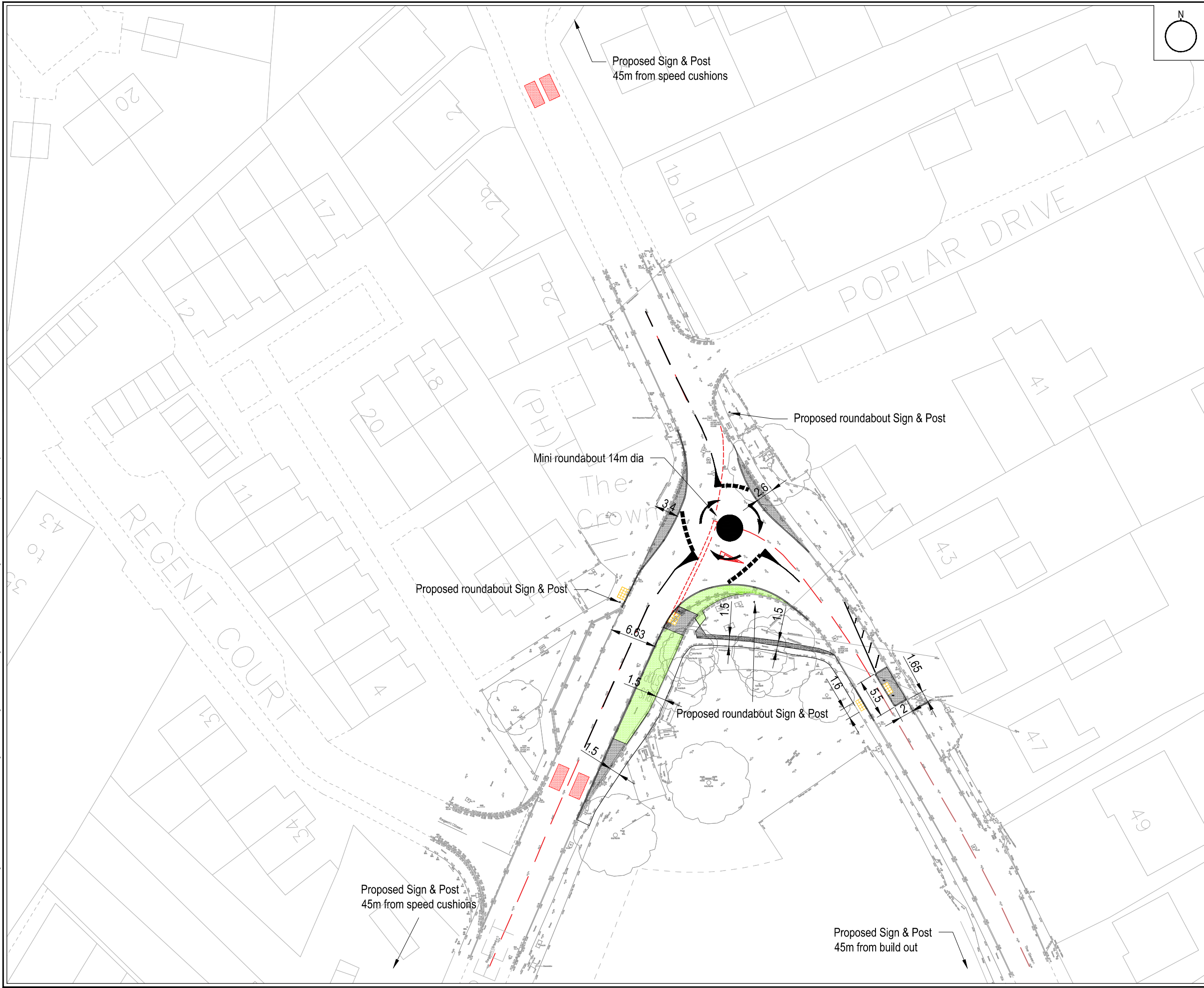

SAFETY, HEALTH AND ENVIRONMENTAL INFORMATION	
In addition to the hazards/risks normally associated with the types of work detailed on this drawing, note the following:	
CONSTRUCTION	
MAINTENANCE / CLEANING	
DECOMMISSIONING / DEMOLITION	
It is assumed that all works will be carried out by a competent contractor working, where appropriate, to an approved method statement	

- Notes:
1. Do not scale from this drawing.
 2. All measurements are in metres unless stated otherwise.
 3. Drawing is constructed on top of a O/S map.
 4. All works should comply with the 'Specification for Highway Works' and 'Design Manual for Roads and Bridges' (DMRB).
 5. Any discrepancies noted on the drawing are to be reported back to the overseeing engineer.

Key:

	Proposed footway
	Proposed speed cushions
	Proposed grass verge
	Proposed tactile
	Proposed kerbs
	Road markings to be removed

DRAFT

A	17/01/20	Build-out moved 1.65m	MH	SH	SH
REV	REV. DATE	PURPOSE OF REVISION	DRAWN	CHKD	APPRVD
Drawn:	MH		Date:	13/01/20	
Design:	MH		Date:	13/01/20	
Checked:	SH		Date:	13/01/20	
Approved:	DL		Date:	13/01/20	

RINGWAY JACOBS
integrated expertise

Central Bedfordshire

Project: **The Green, Stofold**

Drawing Title: **General Arrangement**

Drawing Status: **Preliminary**

Scale: **1:500 @ A3** | **DO NOT SCALE**

Ringway Jacobs No.:

Client No.:

Drawing Number: **CBC-220631-GA-001** | Rev **A**

This drawing is not to be used in whole or part other than for the intended purpose and project as defined on this drawing. Refer to the contract for full terms and conditions.